

# Installation Guide

## Duct By-Pass

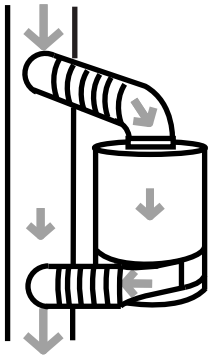

Vertical duct bypass

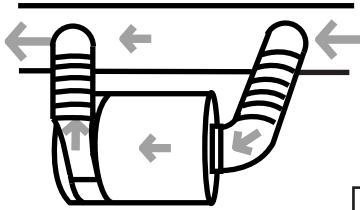

Horizontal duct bypass

6 feet  
between  
connections  
recommended

## Wall mount brackets available

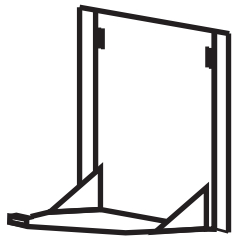

Vertical

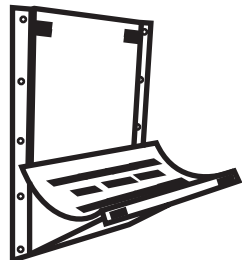

Horizontal

Standard  
5" flanges  
for easy  
connection

No hardware  
connection  
plug-in only



## Other Installations

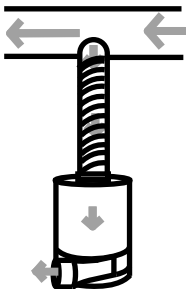

Extraction from duct

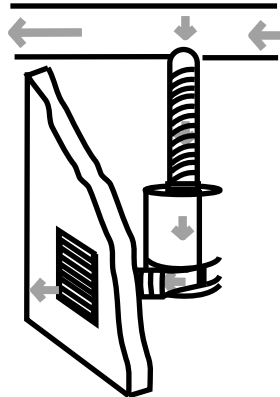

Duct to wall vent

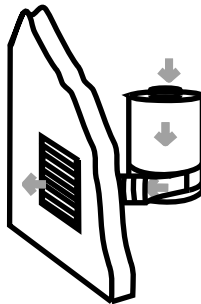

Free air to wall vent

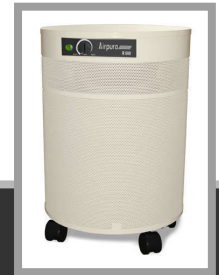

# Operating & Filter Replacement Directions

## R600-W

Thank You for choosing an  
Airpura High Efficiency Air Purifier  
To bring you the benefits of clean indoor air

### To Begin Using Your Airpura...

- Inspect the exterior of your Airpura to verify there is no damage from shipping. If any damage is noted please follow the instructions in the Airpura returns policy.
- Assemble the unit by attaching the top cover and the outlet elbow following the assembly instructions on page 2 of this guide
- Install the unit following the installation instructions on the back cover of this guide
- Plug the unit into a regular grounded 110 volt outlet
- Turn on the unit to MAX and allow it to run for a few minutes
- Set the variable speed control to the level you wish
- The most efficient way to use your Airpura for regular air quality maintenance is to run it at a low speed 24 hours a day 7 days a week

Feel the difference breathing clean air makes  
to your health

# Carbon & Hepa Filter Replacement

## The Activated Carbon Filter

Should be changed as needed in heavy applications and at least every 24 months in normal use.

## The HEPA Filter

Should be replaced at least every 3 to 5 years of normal use

# Pre-Filter Replacement

The pre-filter should be replaced every 4 to 6 weeks.

Always unplug the unit before beginning filter replacement

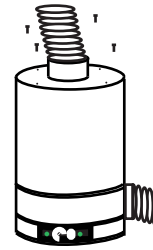

Remove the 4 screws on the top

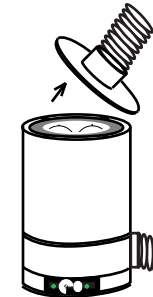

Take off the top



Take off the felt gasket

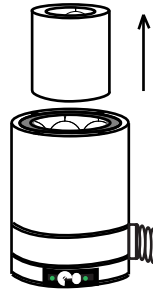

Pull out the carbon filter

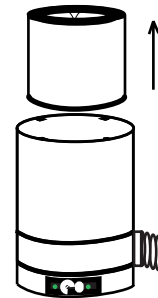

Pull out the hepa filter

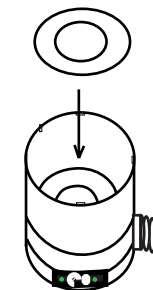

Replace the bottom felt gasket



Put in the new hepa filter

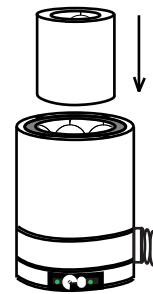

Put in the new carbon filter

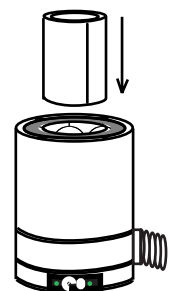

Put in the new pre-filter



Replace the top felt gasket

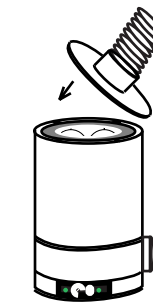

Place the top cover so that the 4 holes align

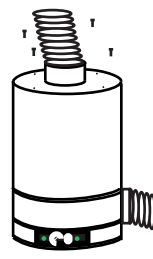

Tighten the 4 screws